

01 à 17 : pièces PLA couche 0.1 mm remplissage 20%

VA : 2 x vis 2 x 7

VB : 6 x vis CHC 3 x 30

VC : 2 x vis CHC 3 x 12

EA : 4 x écrou carré $\phi 3$ mm 5x5

RA : 2 x ressort $\phi 5.55$ x 17.46

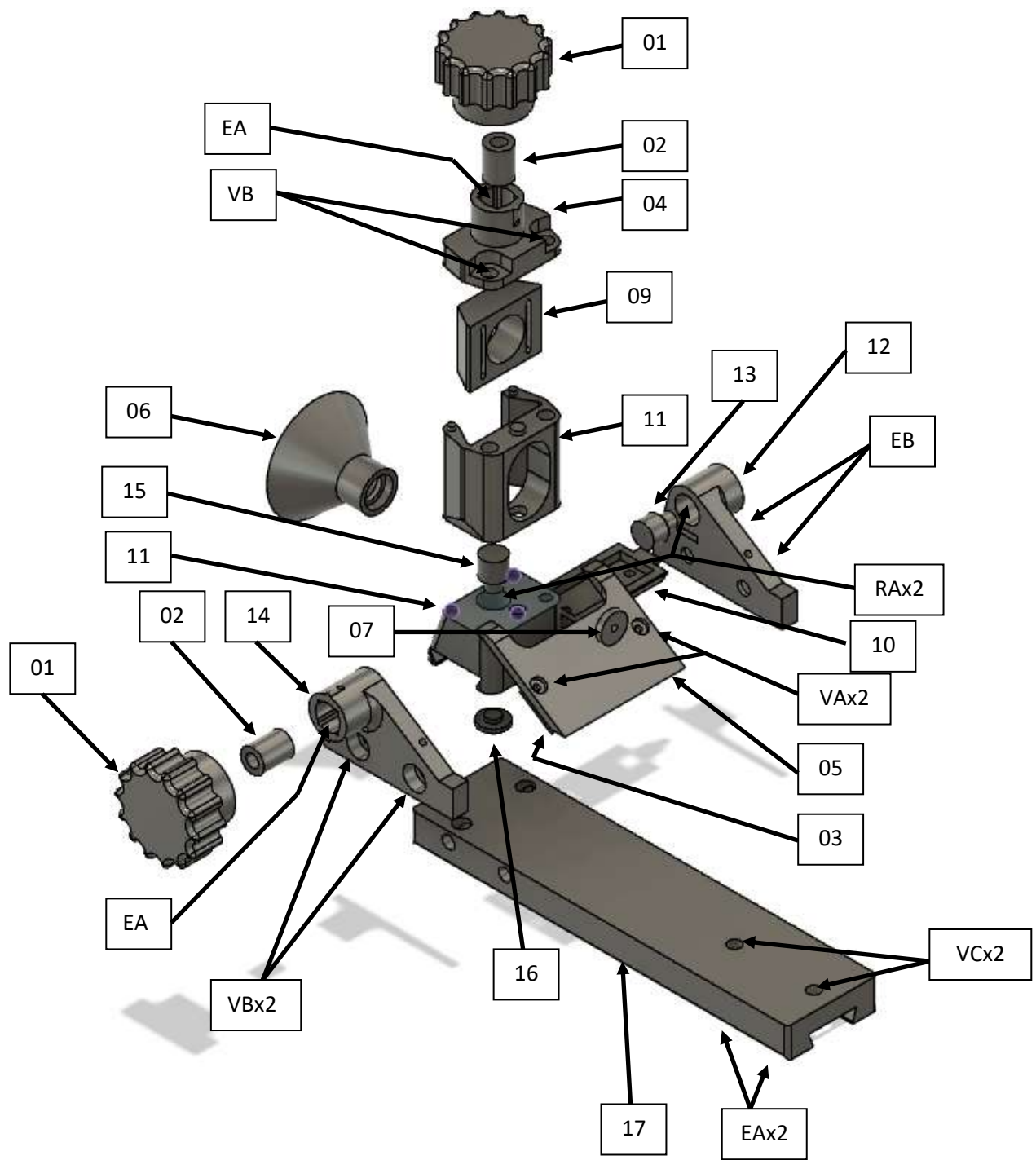

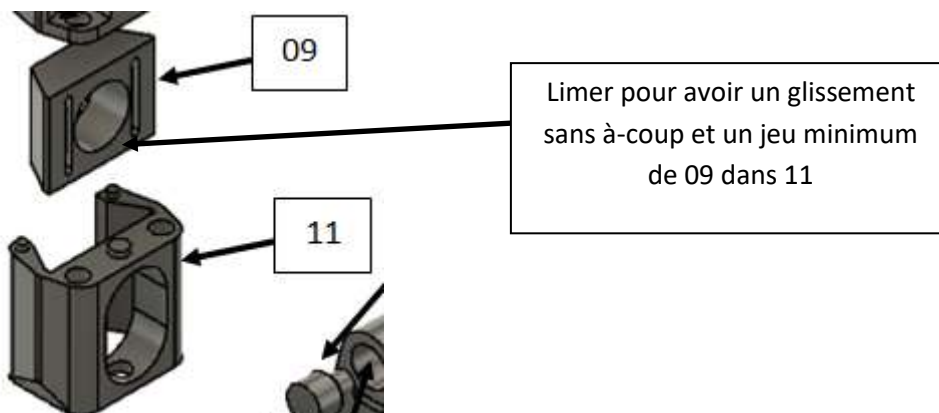
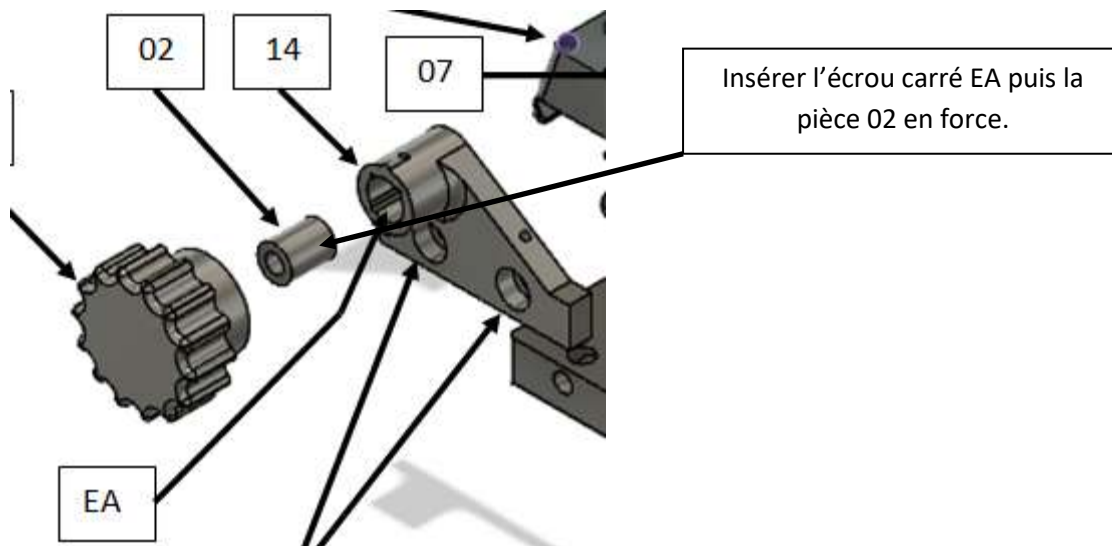
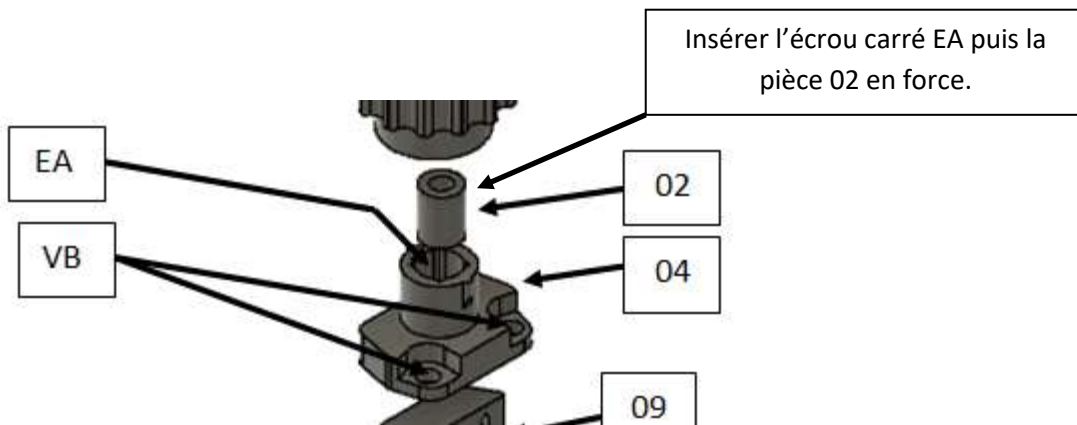

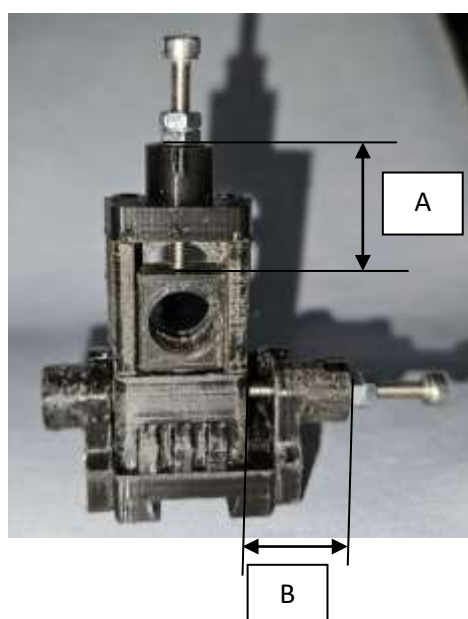
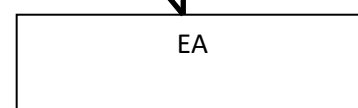
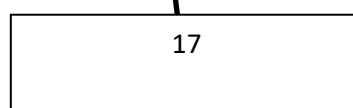
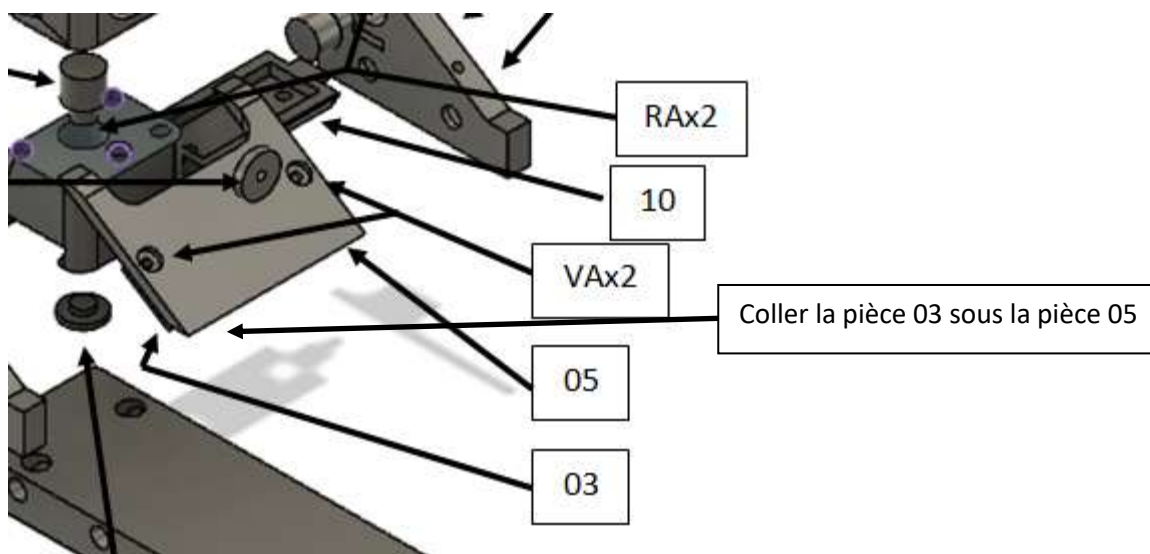

Avec 2 vis CHC 3x30, visser à fond comme ci-contre et mesurer A et B

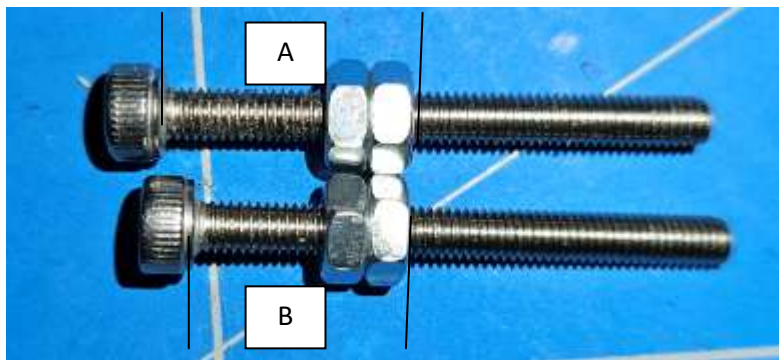

Reporter A et B et couper



Centreur

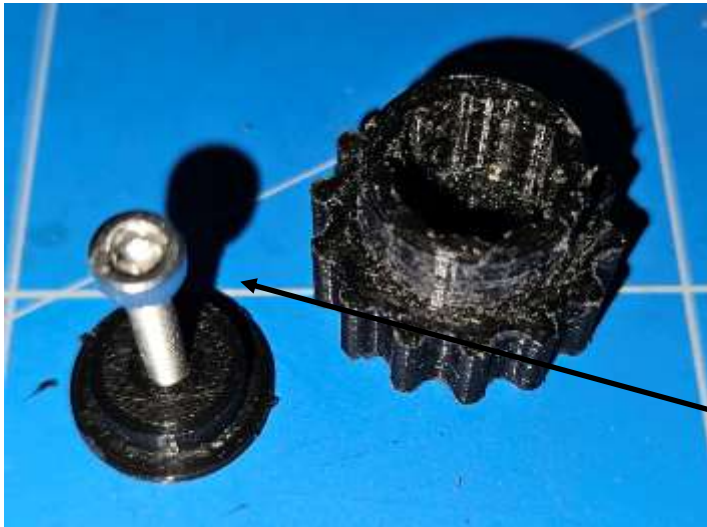

Déposer de la colle sur la
tête de vis



Insérer la tête de vis dans
son logement



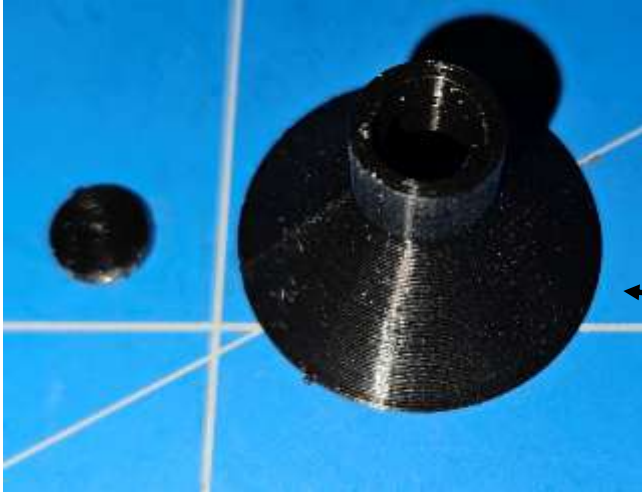

Assembler 06 et 07



14

EA



14

02

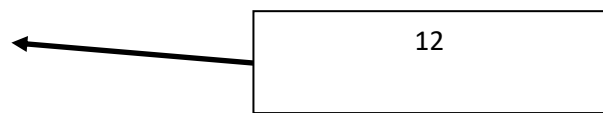

12





Ressort + 13 dans 12

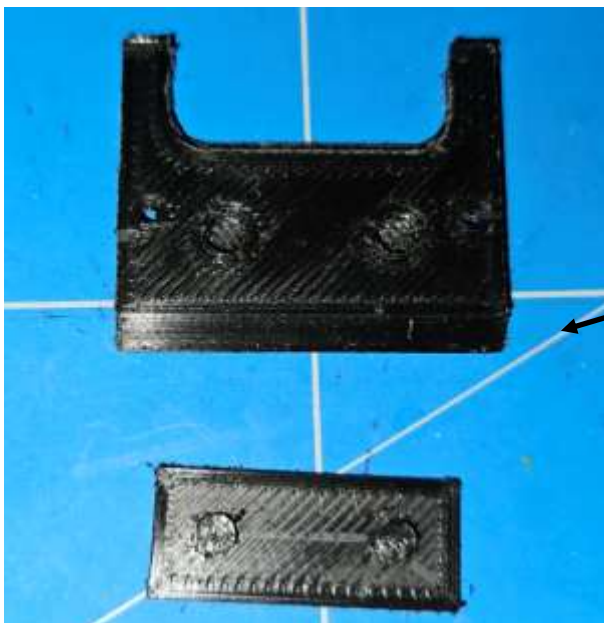

Coller 3 et 5

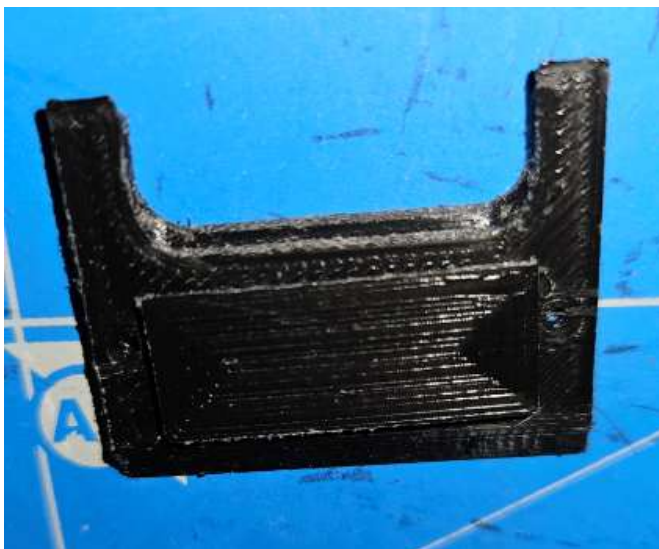

10-11-16

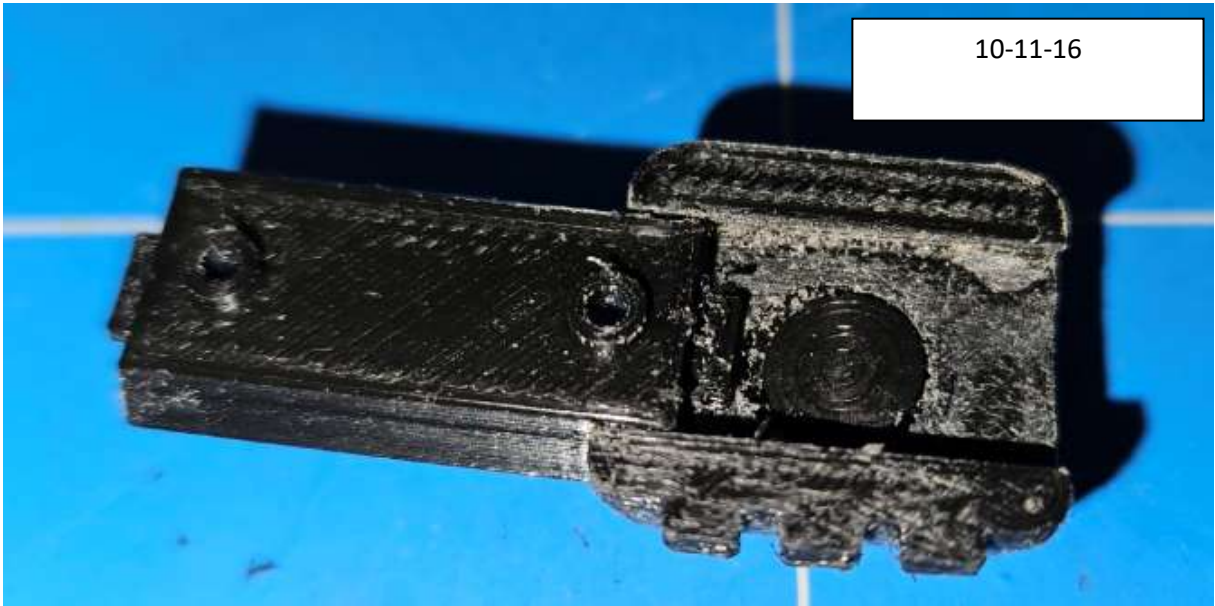

11-15-16-RA

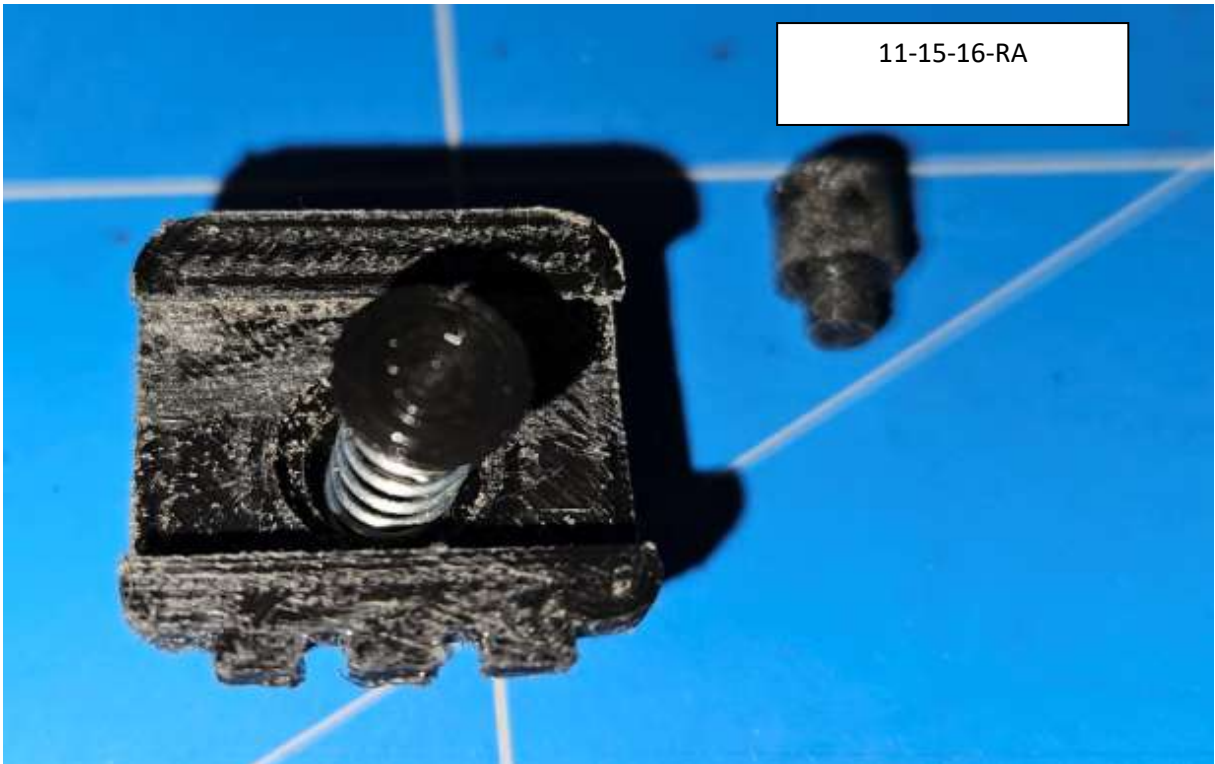

8-10-11-15-RA





